



## MODEL ID: FMWM-443

Height: 4.5" (114.3 mm)

Width: 3" (76.2 mm)

Depth: 4.5" (114.3 mm)

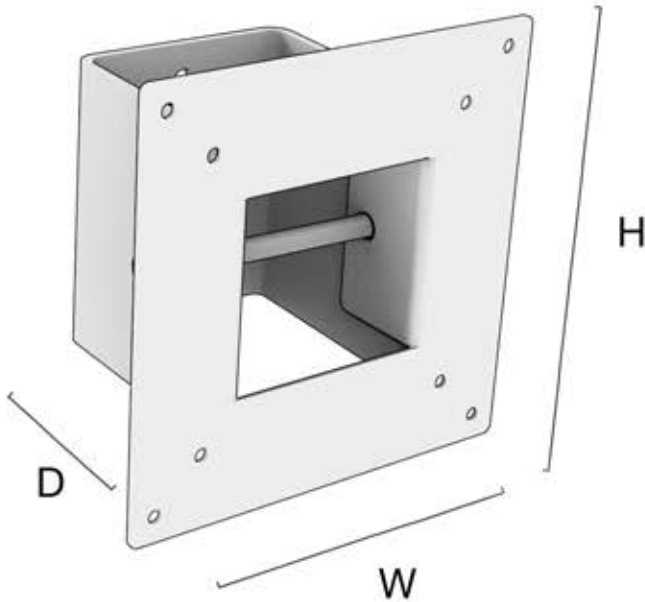

### MOUNTING HOLE SPECIFICATIONS

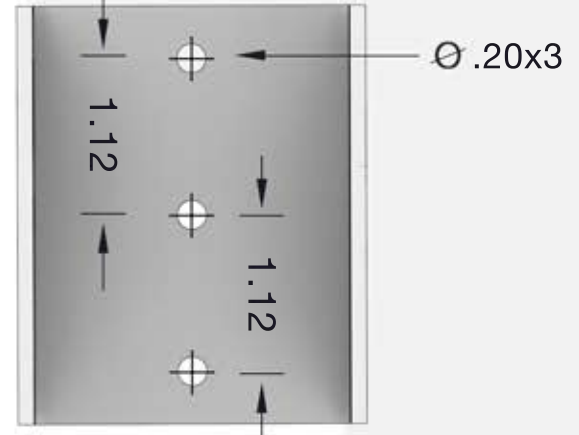

### SPECIFICATIONS

|                             |                   |
|-----------------------------|-------------------|
| <b>Part Number</b>          | AMWM-474          |
| <b>Height</b>               | 4.5 in / 114.3 mm |
| <b>Width</b>                | 3 in / 76.2 mm    |
| <b>Depth</b>                | 4.5 in / 114.3 mm |
| <b>Country of Origin</b>    | Made in USA       |
| <b>Material</b>             | 16 GA CRS         |
| <b>Color</b>                | Flat Black        |
| <b>Shipping Method</b>      | FedEx Ground      |
| <b>Weight Capacity</b>      | 35 lb / 15.87 kg  |
| <b>Screen Size Capacity</b> | 12" to 23.9"      |

### DESCRIPTION

The Vesa Tilt Monitor Mount is designed with versatility and strong hold in mind. Mount your monitor on the wall or other vertical surfaces to increase work area and provide a more ergonomically configured work place. The Vesa Tilt bracket utilizes a mounting plate with VESA hole pattern for attaching a wide selection of makes and models of monitors. The built-in tilt function of the mount allows you to adjust the monitor's vertical or horizontal orientation. This Monitor Mount is manufactured out of medium gauge steel for sturdy construction and finished with a durable, aesthetically enhancing Matte Black powder coat paint. The Vesa Tilt Monitor Mount is the perfect solution for office, home office, reception, institution and other commercial environments.

### WHAT'S INCLUDED

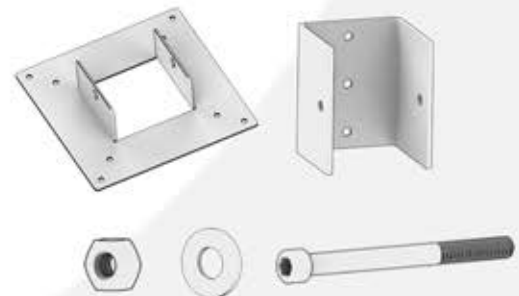

### INSTALLATION

See Page 2 for Further Installation Instructions.

# oeveo

## MODEL ID: FMWM-443

STEP 1: Please review all parts that are mentioned in the spec sheet. Identify the wall mount bracket and install on the wall. If possible find a stud or use drywall anchors to install in a horizontal or vertical position.



STEP 2: Attach the vesa bracket to the monitor first using the M4 screws provided and then fasten the entire system through the wall mount bracket using fasteners provided.

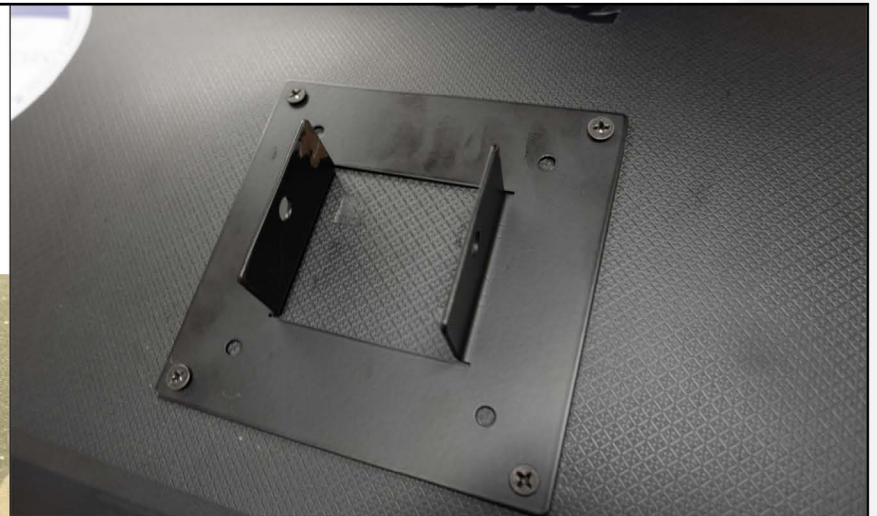

STEP 3: Adjust the tension and tilting motion through the arm and use the 3/16" hex key to tighten once desired position is found.

